



BEVERAGE-AIR®

| | |
|-----------------|------------|
| Project: _____ | AIA# _____ |
| Item: _____ | |
| Location: _____ | SIS# _____ |
| Approved: _____ | |

WTRD119AHC WORKTOP DRAWER REFRIGERATOR

WORKTOP SIDE MOUNT REFRIGERATOR

WTRD119AHC Solid Door Worktop Refrigerator With Drawers
Hydrocarbon Series

MODEL:
WTRD119AHC-4



5 Year Parts/Labor Warranty Available

7 Year Compressor Warranty

CABINET CONSTRUCTION

- Stainless steel front, sides, door and drawers (galvanized back & bottom)
- Interior liner is made of corrosion resistant aluminum
- Stainless steel worktop for added durability
- 16 Gauge stainless steel top
- Full electronic control
- Interior thermometer is standard
- 4" Foamed-in-place backsplash
- Snap-in drawer gaskets
- Self-closing doors with 120° stay-open feature, on cartridge style hinges
- Door opening includes low wattage, anti-condensate heaters
- Magnetic gasket attached to each door for positive seal
- Field-reversible doors
- Four (4) epoxy-coated steel wire shelves
- Upper and lower pull-out drawers accommodate 6" deep pans
- Stainless steel drawer frames supported on telescoping drawer slides
- Drawer slides include locking mechanism that prevents drawer from being inadvertently pulled off cabinet
- 6" Casters, (2) with brakes standard

OPTIONS & ACCESSORIES

- 3 Year parts/labor standard, additional 2 year warranty available
- Stainless steel back
- Stainless steel interior
- Additional shelves
- Shelf clips
- Right or left hinged door
- Locks (solid doors only)
- Bun rack
- Wire shelf divider
- Cutting board
- 3" Casters
- 6" Legs (stainless steel, black or seismic/flange)
- Low profile casters
- Roller kit
- Flat-top with no backsplash (-FLT)
- Remote option* (see note on back on page)

REFRIGERATION SYSTEM

- Uses environmentally friendly, energy efficient R290 refrigerant, and meets all regulatory requirements for CARB, SNAP, DOE & more
- Adaptive defrost
- Epoxy coated evaporator coil
- Refrigerators capable of maintaining product temperature between 36°F and 38°F



Please verify qualifying units by visiting:
www.energystar.gov/cfs

3779 Champion Blvd., Winston-Salem, NC 27105
1-888-845-9800 Fax: 1-336-245-6453
Beverage-Air.com Sales@bevair.com



BEVERAGE-AIR

| MODEL | WTRD119AHC-4 |
|-------------------------------------|----------------------------------------|
| EXTERNAL DIMENSIONAL DATA | |
| Width Overall | 118 7/8" |
| Depth Overall with Handles & Bumper | 35 3/4" |
| Height Overall with 6" Casters | 39 1/2" |
| Number of Drawers | 4 |
| Drawer Openings | 21 5/8" x 10 3/8" 21 5/8" x 10 1/4" |
| Depth with Drawer Extended | 57 1/2" |
| Number of Doors | 2 |
| Depth of Door Open 90° | 55 1/4" |
| INTERNAL DIMENSIONAL DATA | |
| NET Capacity (cubic ft.) | 40.12 |
| Internal Width Overall (in) | 114 7/8" |
| Internal Depth Overall (in) | 26" |
| Internal Height Overall (in) | 25" |
| No. of Shelves | 4 |
| ELECTRICAL DATA | |
| Full Load Amperes | 5.0 |
| REFRIGERATION DATA | |
| Horsepower | 1/3 |
| Capacity (BTU/Hr) | 2629 |
| Heat Rejection (BTU/Hr) | 3943.5 |
| Charge (lbs/grams/ounces) | 0.3086 / 140 / 4.9 |
| SHIPPING DATA | |
| Gross Weight - Crated | 752 lbs |
| Height - Crated | 48" |
| Width - Crated | 122" |
| Depth - Crated | 37" |

*NOTE: Remote units are field wired and come with 6" legs.
Refrigerant must be specified at time of order.

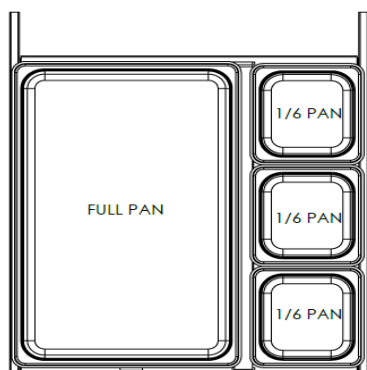

Worktop Refrigerator - Side Mount Model: WTRD119AHC-4

Model Views

Required Clearance: 3" Bottom & 2" Rear

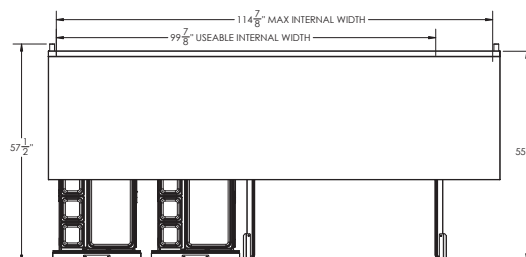

PLAN VIEW

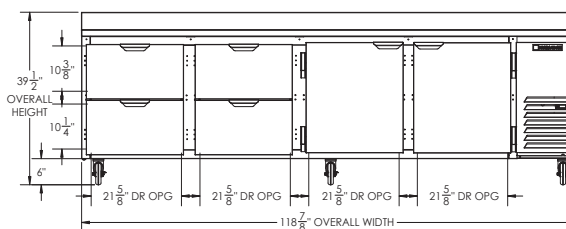

ELEVATION VIEW

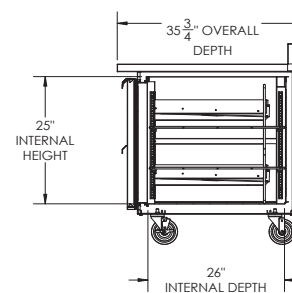

SIDE VIEW



ELECTRICAL CONNECTION



115/60/1
NEMA 5-15P

Unit pre-wired at factory
and include 8' long cord
and plug set.

3779 Champion Blvd., Winston-Salem, NC 27105 1-888-845-9800 Fax: 1-336-245-6453 Beverage-Air.com Sales@bevaair.com

an Ali Group Company



The Spirit of Excellence